

CUTTING TABLE TOOLS & RETRIEVERS

LOAD CONTROL MAGNET



Stay safe. This extremely powerful On/Off Permanent Rare Earth magnet lets you guide loads into position without being in close proximity. Attach the On/Off permanent magnet to a corner or along the side of your load. As the load is lifted, the Load Control Magnet's articulating connection to the lightweight telescoping pole allows you to control and position the load exactly where you want without endangering yourself, others or expensive equipment, should your lifting device fail.

FEATURES:

- » Powerful On/Off Rare Earth Magnet
- » Buy the magnet separately, use your own pole
- » Works on Flat and Pipe
- » Pole telescopes from 6' to 12'

Hold - lbs (kg)	Pole Included	Length (in)	Extended Length (in)	Weight (lbs)	Model No.
150 (68.04)	No	7	N/A	1.20	LCM0150-01
150 (68.04)	Yes	80	147	2.70	LCM0150-02
450 (204.12)	No	8.50	N/A	4.70	LCM0450-01
450 (204.12)	Yes	83	150	6.20	LCM0450-02

Note: Magnet connector accepts a standard paint roller handle extension thread.



RAPIDFIRE RETRIEVER®



FEATURES:

- » Retrieve hot parts off cutting tables with speed & precision!
- » Increase production while reducing the potential for injury
- » Powerful Rare Earth Magnet holds part securely
- » "On-Command" release with just a quick blast of shop air
- » Actuate release with just one finger, it's as simple as the pull of a trigger

Lift - lbs (kg)	Dia. (in)	Length (in)	Weight (lbs)	Model No.
35.0 (15.88)	3	24	2.1	RFR2400
35.0 (15.88)	3	36	2.3	RFR3600
35.0 (15.88)	3	48	2.5	RFR4800
16.0 (7.40)	1.5	7	0.5	RFR7-15
35.0 (15.88)	3	7	0.8	RFR7-30

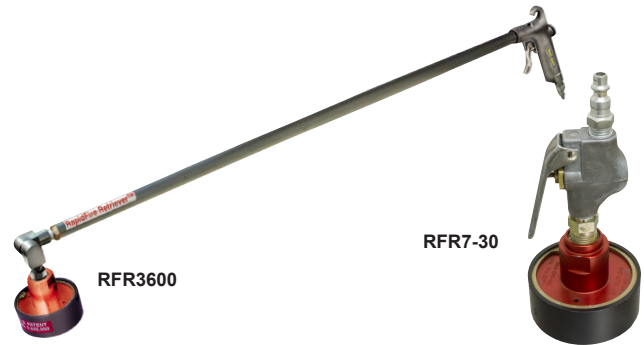

MAGNETIC SHEET HANDLERS



FEATURES:

- » Lift or move sheets, plates, hot or oily parts
- » Handle sheets stacked horizontally or vertically
- » Protect workers from cuts, slivers, nicks & burns
- » Increase productivity

Note: Not intended to be used with a crane

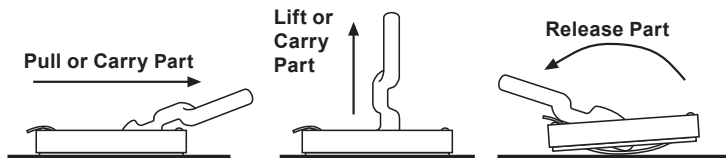

Lift - lbs (kg)	Th. (in)	Wd. (in)	Handle Ln. (in)	Overall. Ln. (in)	Mag. Ln. (in)	Mag. Th. (in)	Wt. (lbs)	Max. Penetration (in)	No. of Poles	Model No.
50.0 (22.6)	4	3-5/8	8	11-1/2	6-1/8	1-3/8	3.75	3/16	4	B100
125.0 (56.7)	4	7-1/4	8	11-1/2	6-1/8	1-3/8	6.25	5/16	6	B250
200.0 (90.7)	4	7-1/4	8	11-1/2	6-1/8	1-3/8	7.25	5/16	8	B400
300.0 (136.0)	4	7-1/4	8	11-1/2	6-1/8	1-3/8	8.25	5/16	10	B600